

**AP MORGAN**



**Long Meadow Road, Lickey End, Bromsgrove**  
£1,995 per month



**Features:**

- Well-presented detached family home
- Desirable location of Lickey End
- Four good-sized bedrooms
- Family bathroom, ground floor w/c & en-suite to master
- Lounge, dining room & conservatory
- Kitchen & separate utility room
- Garage & driveway
- Large rear garden

**Description:**

An excellent opportunity to let this well-presented four-bedroom detached family home, situated in the desirable location of Lickey End, Bromsgrove.

The property is approached via a driveway providing access to the garage via an up-and-over door, with an enclosed porch leading to the front entrance.

Inside, the ground floor layout comprises: entrance hallway, spacious lounge with double doors opening into a separate dining room, which in turn has sliding doors leading to the conservatory. The fitted kitchen offers a range of units and leads to a separate utility room with access to the ground-floor W/C.

On the first floor, the landing provides access to a master bedroom with modern en-suite shower room, three further well-proportioned bedrooms, and a family shower room.

Outside, the generous rear garden is laid mainly to lawn, with a paved patio seating area and a side access gate to the frontage.

Lickey End is ideally located between Barnt Green and Bromsgrove, at the base of the Lickey Hills. The area benefits from excellent transport links, including easy access to the M5 and M42 motorways, a reputable first school, and a range of local amenities.

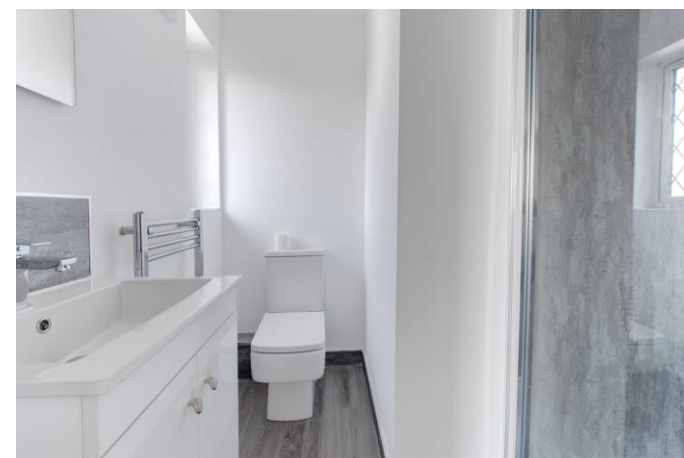

**Details:**

**Hall**

**Lounge** 16'4" x 10'8" (4.98m x 3.25m)

**Dining Room** 10' x 9' (3.05m x 2.74m)

**Kitchen** 10' x 10'3" (3.05m x 3.12m)

**Utility Room** 4'11" x 6'1" (1.5m x 1.85m)

**W/C**

**Conservatory** 10'4" x 9'11" (3.15m x 3.02m)

**Garage** 16'4" x 8'1" (4.98m x 2.46m)

**Landing**

**Master Bedroom** 15'6" x 11'6" (4.72m x 3.5m)

**En-Suite**

**Bedroom Two** 14'2" x 8'3" (4.32m x 2.51m)

**Bedroom Three** 11'3" x 8'3" (3.43m x 2.51m)

**Bedroom Four** 7'8" x 11'4" (2.34m x 3.45m)

**Shower Room** 7'8" x 5'10" (2.34m x 1.78m)

**EPC Rating:** To be confirmed

**Council Tax Band:** E (tbc by solicitors).

**Tenure:** Freehold (tbc by solicitors).

For more information or to arrange a viewing, please call us on 01527 910 300.





How can we help you?

Need a mortgage?

We recommend Wiser Mortgage Advice. They will search the market for you to ensure you get the right lender and mortgage deal. They typically achieve mortgage offers much more quickly than if you were dealing with lenders directly. The initial appointment is free and without obligation. Call us on 01527 910 300, or visit their website for more information: [www.wisermortgageadvice.co.uk](http://www.wisermortgageadvice.co.uk)

Property to sell?

If you need to sell a property in order to buy, you ideally need to be on the market at least (and preferably Sold STC) before viewing, otherwise you may lose out to other buyers when the right property comes along. In these circumstances we can get your property 'live' quickly. Just book a free valuation and we will visit your property and discuss your needs.

Need a solicitor?

A good solicitor can save you literally weeks of time in the buying/selling process, reducing the stress levels of all involved. We will instruct a reputable firm that is competitive on cost and very reliable. Just ask for a quote.

Need a removal company and storage?

A professional removal company takes the stress out of moving. Knowing that your belongings are safe and insured far outweighs any small savings by trying to do it yourself or using a man-and-a-van service. We work closely with and recommend Cube Removals as the leading local firm. For peace of mind and a reliable service call them on 0800 193 0000 or visit their website, [cuberemovals.co.uk](http://cuberemovals.co.uk), to arrange a survey.

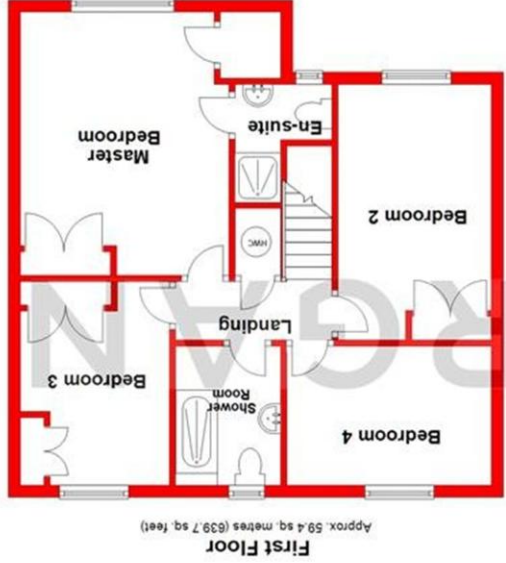

Total area: approx. 135.5 sq. metres (1458.1 sq. feet)

Whilst every attempt has been made to ensure the accuracy of the floorplan contained here, measurements of doors, windows, rooms, and any other items are approximate and no responsibility is taken for any error, omission or mis-statement. This plan is for illustrative purposes only and should be used as such by any prospective purchaser. The services, systems and appliances shown have not been tested and no guarantee as to their operability or efficiency can be given.

Plan produced using Planlup.

No statement in these details is to be relied upon as representation of fact, and purchasers should satisfy themselves by inspection or otherwise as to the accuracy of the statements contained within. These details do not constitute any part of any offer or contract. AP Morgan and their employees and agents do not have any warranty or representation whatsoever in respect of this property. These details and all statements herein are provided without any responsibility on the part of AP Morgan or the vendors. Equipment: AP Morgan has not tested the equipment or central heating system mentioned in these particulars and the purchasers are advised to satisfy themselves as to the working order and condition. Measurements: Great care is taken when measuring, but measurements should not be relied upon for ordering carpets, equipment, etc. The Laws of Copyright protect this material. AP Morgan is the Owner of the copyright. This property sheet forms part of our database and is protected by the database right and copyright laws. No unauthorised copying or distribution without permission.